



Martensville High School Urban Busing

Martensville in-town busing is offered to Martensville High School students based on their distance from the school. The Prairie Spirit Board of Education determined the criteria for urban busing in the City of Martensville. The criteria is a walking distance of more than 1 kilometer from the school. The walking distance is calculated using Prairie Spirit's electronic bus mapping program. Urban busing is only available to Martensville High School students living within the boundaries shown on the following high school maps.

Students new to the Martensville busing system or students who have moved within the community since last being issued a bus pass will need to complete a bus transportation request form. [Martensville Urban Bus Service Request forms](#) are available on the Prairie Spirit [website](#) or from your local school. Please allow a one-week turnaround time for a bus pass to be completed. Bus passes will be delivered on a weekly basis to your child's school. Bus passes will be sent home from school with your child or you can pick up the pass at the school. You do not need to apply for a new bus pass annually as new passes will be issued to students in June of each year and sent home with report cards.

Only students with bus passes will be allowed to ride the bus. The bus pass will include the bus number, bus stop number and description of the bus stop. The student must get on the bus at the stop indicated on the bus pass.

September 2015

Please check Bus Stop Times at the beginning of each school year and throughout the month of September. Times may be adjusted as we are unable to anticipate actual times until the majority of students have registered for bus service.

Contacts:

Bill Steckler, Conveyance Manager
374-2496

Nancy Matechuk, Routing & Planning
374-2496

Prairie Spirit School Division
Box 809, 121 Klassen Street East
Warman, SK S0K 4S0
683-2800
www.spiritsd.ca



Martensville High School Urban Bus Stop Times 2016-17

| Stop No. | Bus No. | Driver | *Leave Time | Drop-Off Time | Address |
|----------|---------|------------------|-------------|---------------|---|
| 1 | 368 | Linda Tinkler | 8:34 a.m. | 3:25 p.m. | Baycroft Drive alley entrance between legs of Hiebert Crescent (north side) |
| 2 | 368 | Linda Tinkler | 8:32 a.m. | 3:35 p.m. | Reddekopp Drive Water Reservoir (north side) |
| 3 | 179 | Crystal Thiessen | 8:30 a.m. | 3:41 p.m. | 1st Avenue South between 2 nd and 3 rd Streets South across from 218 – 1 st Avenue South (east side) |
| 4 | 293 | Linda Unger | 8:30 a.m. | 3:38 p.m. | 6 th Street South and 2 nd Avenue South (south side) across from 601 – 2 nd Avenue South |
| 5 | 230 | Vannia Siller | 8:26 a.m. | 3:14 p.m. | 6 th Avenue South (west side) just north of Gerbrandt Place |
| 6 | 230 | Vannia Siller | 8:30 a.m. | 3:17 p.m. | 8 th Avenue South and Rock Hill Lane (east side) by mailbox |
| 7 | 179 | Crystal Thiessen | 8:24 a.m. | 3:46 p.m. | MacCormack Road (south side) across from drainage ditch between 289 and 350 MacCormack Road |
| 8 | 368 | Linda Tinkler | 8:26 am | 3:13 | 3 rd Street North in Lake Vista Park (North of 383 Cowan Crescent) |
| 9 | 368 | Linda Tinkler | 8:27 am | 3:14 | Cowan Avenue just north of Parr Hill Drive |

TENTATIVE TIMES: PLEASE REVISIT WEBSITE FOR UPDATES IN LATE AUGUST, SEPTEMBER & PERIODICALLY THROUGH THE SCHOOL YEAR

Bus passes are processed weekly. Bus Passes are sent to schools. Please contact your local school for pickup of passes.

Plan No 102066229

CENTENNIAL DRIVE NORTH
Centennial Drive North

910
900
830
810
800
740
740
720
710
700

recreation Boulevard
20



1

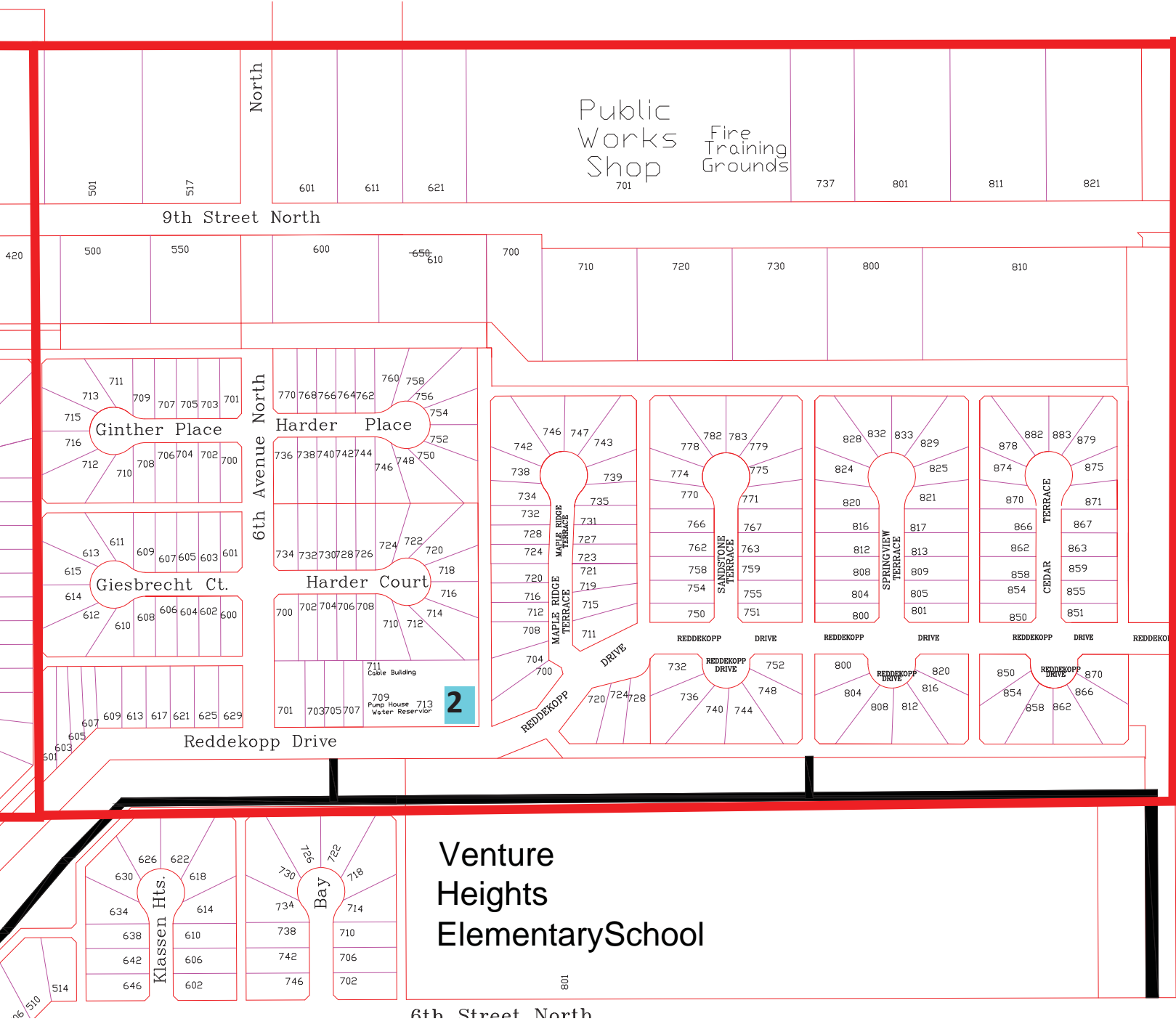

Public Works
701
Fire Training Grounds

9th Street North

North

6th Avenue North

Reddekopp Drive

Venture Heights Elementary School
801

6th Street North

Ginther Place

Harder Place

Giesbrecht Ct.

Harder Court

MAPLE RIDGE TERRACE

SANDSTONE TERRACE

SPRINGVIEW TERRACE

CEDAR TERRACE

REDDEKOPP DRIVE

REDDEKOPP DRIVE

REDDEKOPP DRIVE

REDDEKOPP DRIVE

REDDEKOPP DRIVE

REDDEKOPP DRIVE

2

Klassen Hts.

Bay

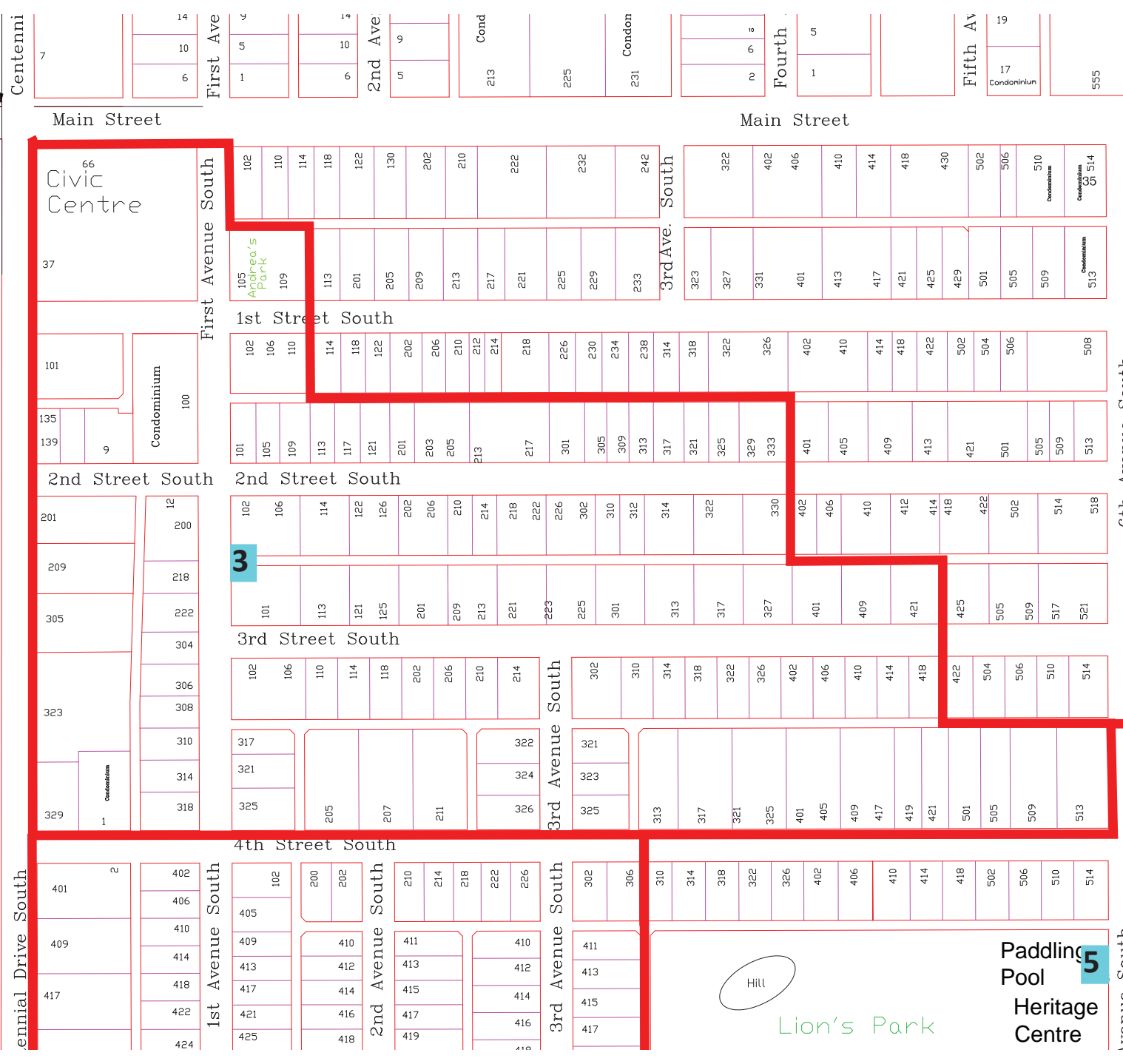

66
Civic
Centre

105
Ancho's
Park

Lion's Park

Hill

5
Paddington
Heritage
Centre

3

5

Highway #12

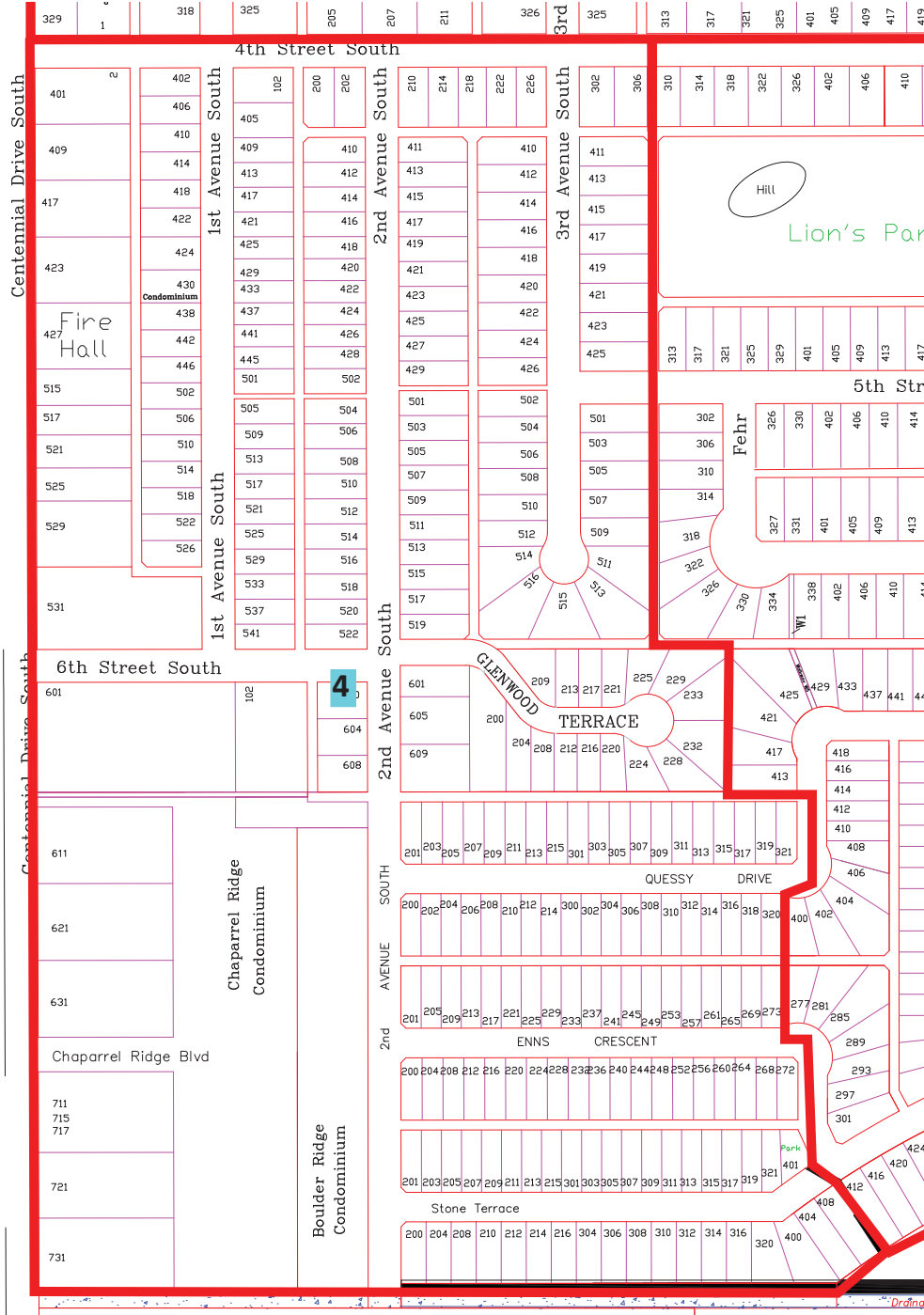

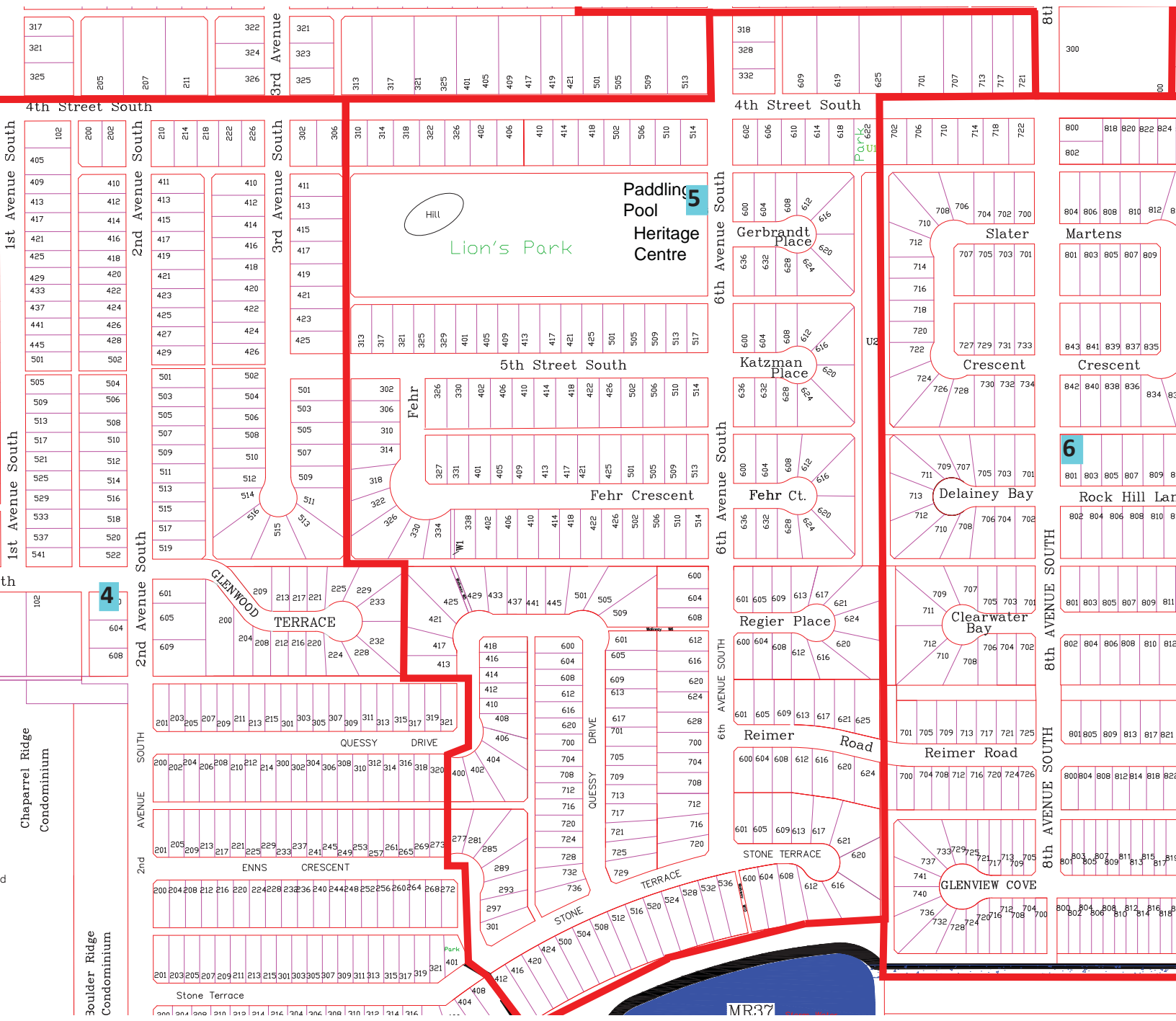

Hill
Lion's Park

Paddling Pool
Heritage Centre

5th Street South

Fehr Crescent

GLENWOOD TERRACE

QUESSY DRIVE

ENNS CRESCENT

QUESSY DRIVE

STONE TERRACE

Fehr Ct.

Regier Place

Reimer Road

STONE TERRACE

Delaney Bay

Clearwater Bay

Reimer Road

GLENVIEW COVE

5

4

1st Avenue South

1st Avenue South

Chaparral Ridge Condominium

Boulder Ridge Condominium

2nd Avenue South

2nd Avenue South

2nd AVENUE SOUTH

2nd AVENUE SOUTH

3rd Avenue South

3rd Avenue South

3rd AVENUE SOUTH

3rd AVENUE SOUTH

4th Street South

6th Avenue South

6th AVENUE SOUTH

6th AVENUE SOUTH

8th Avenue South

8th AVENUE SOUTH

8th AVENUE SOUTH

8th AVENUE SOUTH

Gerbrandt Place

Katzman Place

Katzman Place

Reimer Road

Reimer Road

Reimer Road

STONE TERRACE

Slater

Crescent

Delaney Bay

Clearwater Bay

Reimer Road

GLENVIEW COVE

Martens

Crescent

Rock Hill Lane

6

8th AVENUE SOUTH

8th AVENUE SOUTH

Park

Park

Park

Park

Park

Park

Park

Park

Park

Park

Park

MR37

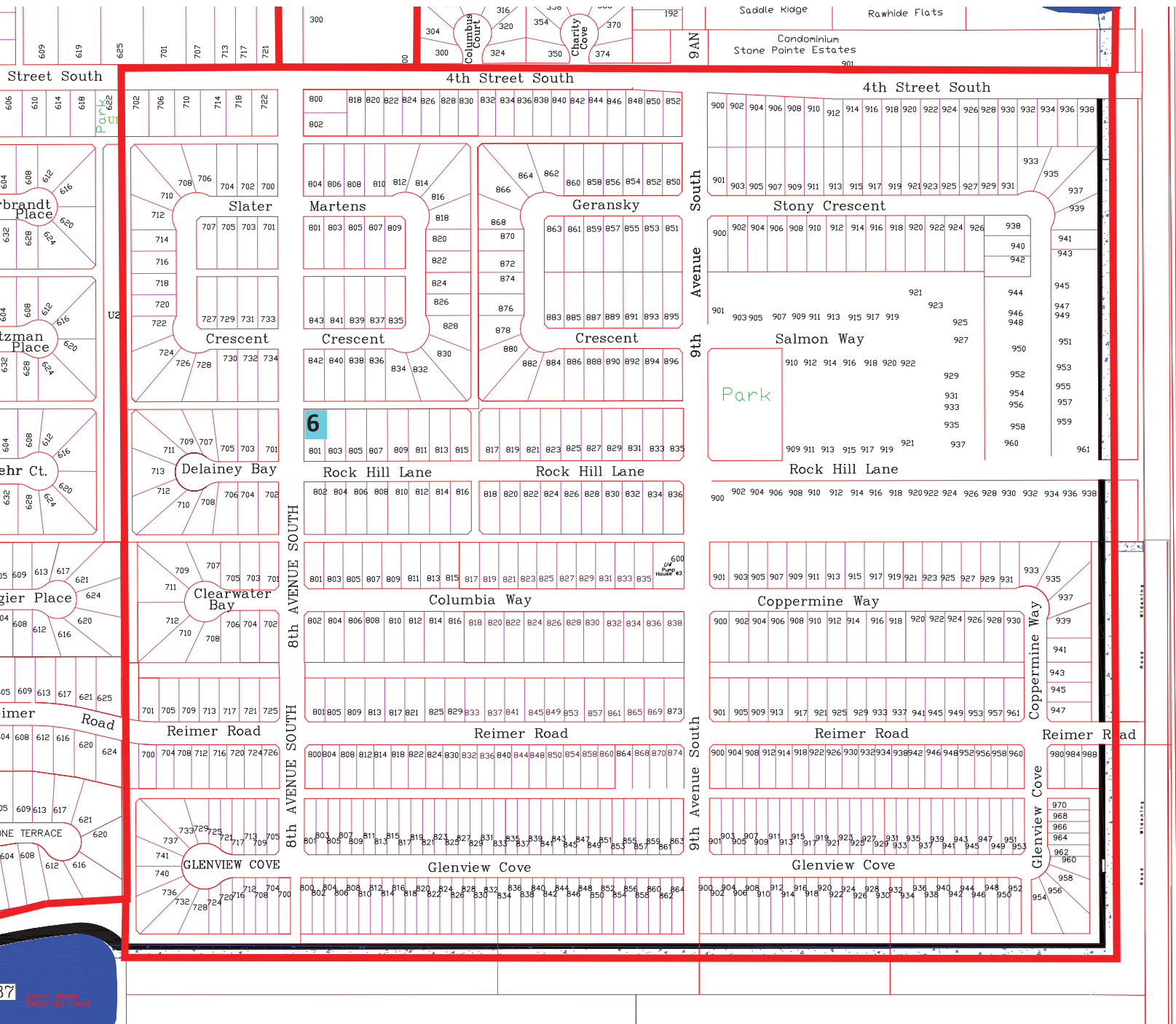

6

Park

Coppermine Way

Glenview Cove

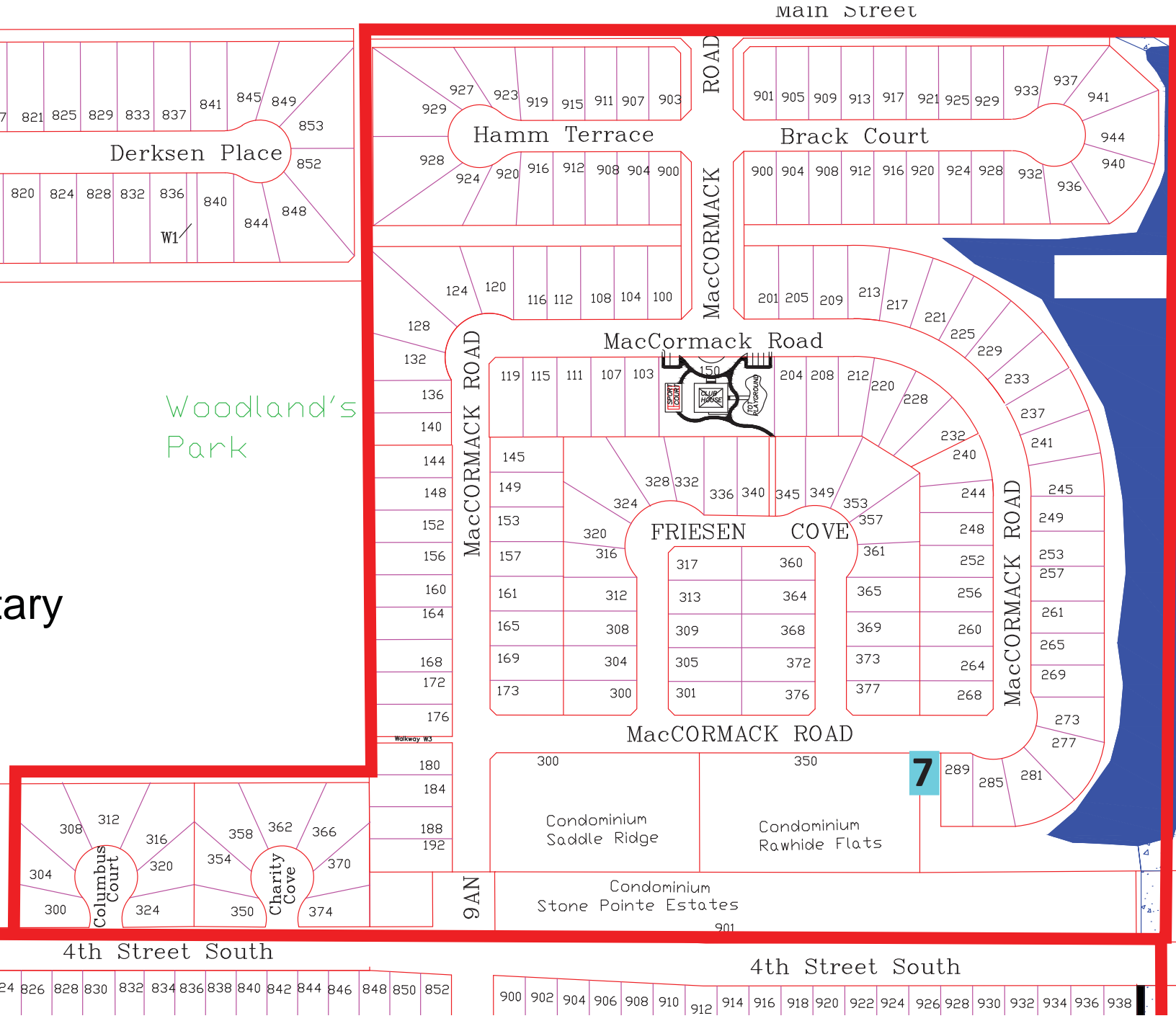

main Street

Derksen Place

Hamm Terrace

Brack Court

Woodland's Park

MacCormack Road

FRIESEN COVE

Columbus Court

Charity Cove

MacCORMACK ROAD

Condominium Saddle Ridge

Condominium Rawhide Flats

Condominium Stone Pointe Estates

7

4th Street South

4th Street South

824 826 828 830 832 834 836 838 840 842 844 846 848 850 852

900 902 904 906 908 910 912 914 916 918 920 922 924 926 928 930 932 934 936 938

ary

W1

Walkway WS

9AN

ROAD

MacCORMACK ROAD

MacCORMACK ROAD

MacCORMACK ROAD

4
a.

Road Widening F

10TH AVENUE NORTH

16TH AVENUE NORTH

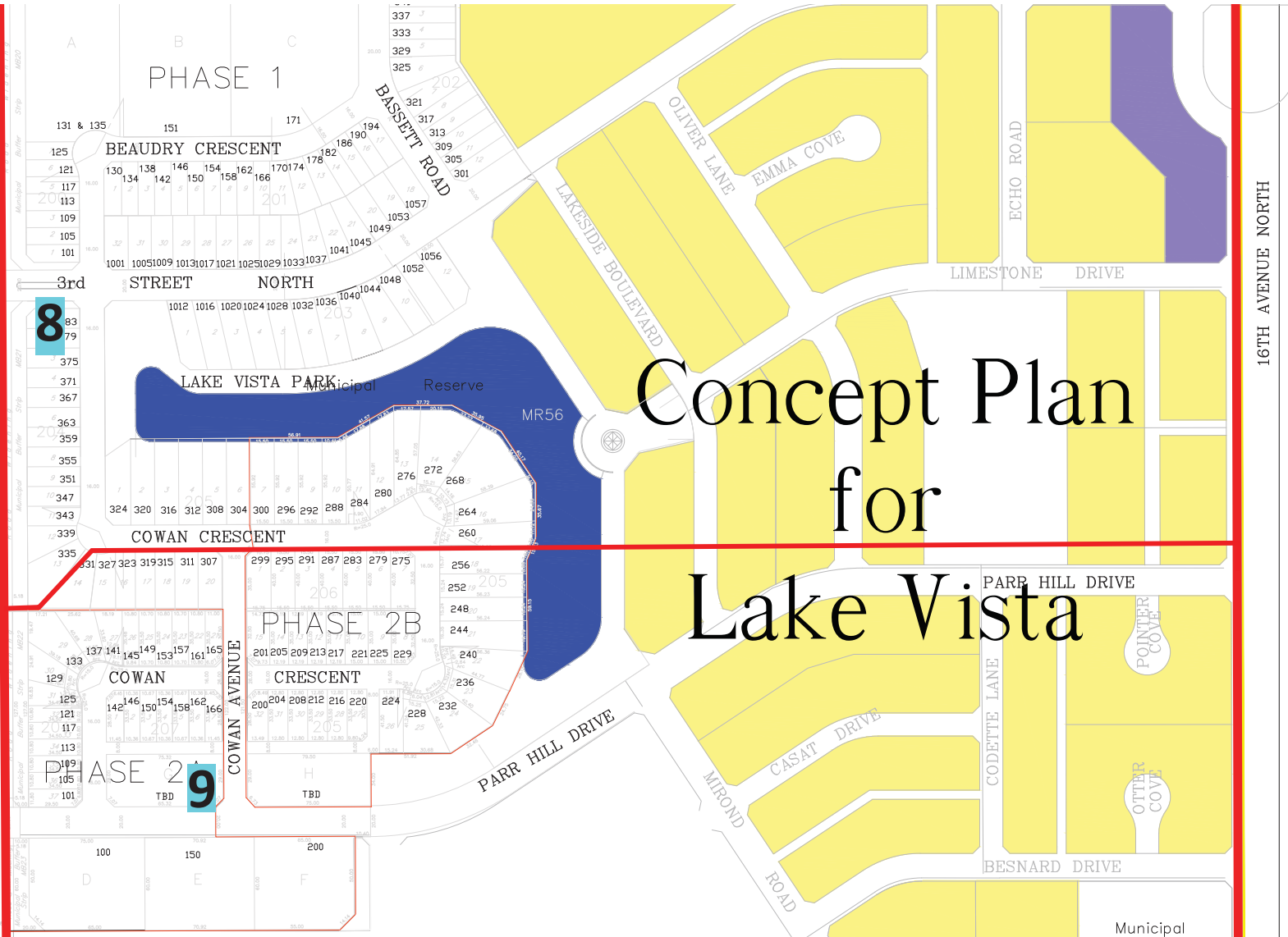

Concept Plan for Lake Vista

Municipal

